

CARBON STEEL FLANGE

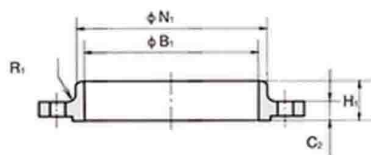

SLIP-ON

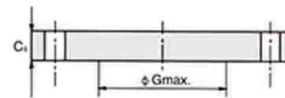

BLIND

EN 1092-1:2007

DIMENSIONS OF PN16 FLANGES

DN	Outside diameter	Diameter of bolt circle	Diameter of bolt hole	Bolt number	Outside diameter of neck A	Bore diameters		Flange th		Raised face		Length H ₁	Neck dia N ₂	Corner radii R ₁
						B ₁	B ₂	C ₁	C ₂	d ₁	f ₁			
15	95	65	14	4	21.3	22.0	25	14	16	45	2	22	35	4
20	105	75	14	4	26.9	27.5	31	16	18	58	2	26	45	4
25	115	85	14	4	33.7	34.5	38	16	18	68	2	28	52	4
32	140	100	18	4	42.4	43.5	47	18	18	78	2	30	60	6
40	150	110	18	4	48.3	49.5	53	18	18	88	3	32	70	6
50	165	125	18	4	60.3	61.5	65	20	18	102	3	28	84	6
65	185	145	18	4	76.1	77.5	81	20	18	122	3	32	104	6
80	200	160	18	8	88.9	90.5	94	20	20	138	3	34	118	6
100	220	180	18	8	114.3	116.0	120	22	20	158	3	40	140	8
125	250	210	18	8	139.7	141.5	145	22	22	188	3	44	168	8
150	285	240	22	8	168.3	170.5	174	24	22	212	3	44	195	10
200	340	295	22	12	219.1	221.5	226	26	24	268	3	44	246	10
250	405	355	26	12	273.0	276.5	281	29	26	320	3	46	298	12
300	460	410	26	12	323.9	327.5	333	32	28	378	4	46	350	12
350	520	470	26	16	355.6	359.5	365	35	30	438	4	57	400	12
400	580	525	30	16	406.4	411.0	416	38	32	490	4	63	456	12
450	640	585	30	20	457.0	462.0	467	42	34	550	4	68	502	12
500	715	650	33	20	508.0	513.5	519	46	36	610	4	73	559	12
600	840	770	36	20	610.0	616.5	622	55	40	725	5	83	658	12
700	910	840	36	24	711.0	To be specified by the purchaser	721	63	40	795	5	83	760	12
800	1025	950	39	24	813.0		824	74	41	900	5	90	864	12
900	1125	1050	39	28	914.0		926	82	48	1000	5	94	968	12
1000	1255	1170	42	28	1016.0		1030	90	59	1115	5	100	1072	16